

CATALOG NUMBER	STRANDED COPPER CONDUCTOR ACCOMMODATED				BOLT SIZE	METRIC BOLT SIZE	DIMENSIONS								
	CODE (AWG)	NAVY	METRIC SIZE (CLASS 2)				B	C	E	K DIA.	L	N	O.D.	T REF.	Z MIN.
YA8C2N	#8 AWG	23	10mm ² STR [4.1] CLASS 2 & 5		1/2	M12	.81 [21]	↑	↑	↑	4.08 [104]	↑	.27 [7]	↑	↑
YA6C2N	#6 AWG	----	----		1/2	M12	1.12 [28]	↑	↑	↑	4.40 [112]	↑	.29 [7]	↑	↑
YA5C2N	#5 AWG	30	16mm ² STR [5.3]	1/2	M12	4.43 [113]					.30 [8]				
YA4C2N	#4 AWG	40	----	1/2	M12	4.45 [113]					.34 [9]				
YA3C2N	#3 AWG #2 SOL	50	25mm ² STR [6.6]	1/2	M12	1.25 [32]	↓	↓	↓	↓	4.62 [117]	↓	.38 [8]	↓	↓
YA2C2N	#2 AWG	60	----	1/2	M12	4.64 [118]					.42 [11]				

TOLERANCE BLOCK

CONNECTOR SIZE	TOLERANCES						
	B	C	E	K DIA.	L	N	O.D.
-8C THRU -25	±.06	±.04	±.02	±.02	±.09	±.03	±.01
-26 THRU -34	±.08	±.04	±.02	±.02	±.12	±.03	±.01
-35 AND UP	±.09	±.06	±.02	±.02	±.15	±.06	±.01

INSTALLATION TOOLING (# CRIMPS)

CATALOG NO.	COLOR CODE	DIE INFORMATION		MECHANICAL RATCHET					HYDRAULIC					DIELESS (# CRIMPS)	WIRE STRIP LENGTH		
		DIE INDEX	TYPE	YIMRTC	OUR840	MD6 MD7	MD6--R2	MD7-34R	Y500CT PAT600	Y34A Y34B Y34BH	Y35, Y39, Y750, PAT750	Y46	Y45			Y48B	Y60BHU
YA8C2N	RED	49	RED DIE SET	RED (2)	X8CRT(1) W8CVT(1)	W8CRT(1) W8CVT(1)	W8CRT(1) W8CVT(1)	W8CRT(1) W8CVT(1)	X8CRT(2) W8CRT(1) W8CVT(1)	-----	U8CRT (1)	U8CRT (1)	U8CRT (1)	-----	-----	RATCHET: Y8MRB-1(1) MECHANICAL: MY29-3(1), MY29-11(1), MRC-840(2) HYDRAULIC: Y81K-SERIES(1) PAT81K-SERIES(1) Y81KFT-SERIES(2) Y4PC834-SERIES(2)	7/8"
YA6C2N YA5C2N	BLUE	7 374	BLUE DIE SET	BLUE (2)	X5CRT(2)	W5CRT(2) W5CVT(2)	W5CRT(2) W5CVT(2)	W5CRT(2) W5CVT(2)	X5CRT(2) W5CRT(2) W5CVT(2)	----- B6CD(1) A6CD(1) Y34PR	U5CRT(2) U8CABT(2)	U5CRT(2) U8CABT(2)	U5CRT(2) U8CABT(2)	-----	-----	MECHANICAL: MY29-3(2) MY29-11(2) MRC-840(2) HYDRAULIC: Y644M(1) PAT644M(1) Y81K-SERIES(1) PAT81K-SERIES(1) Y81KFT-SERIES(2) Y4PC834-SERIES(2)	1-3/16"
YA4C2N	GRAY	8 346	GRAY DIE SET	GRAY(4)	X4CRT(2)	W4CRT(2) W4CVT(2)	W4CRT(2) W4CVT(2)	W4CRT(2) W4CVT(2)	X4CRT(2) W4CRT(2) W4CVT(2)	----- B4CD(1) A4CD(1) Y34PR	U4CRT(2) U4CABT(2)	U4CRT(2) U6CABT(2)	U4CRT(2) U6CABT(2)	-----	-----		1-3/16"
YA3C2N	WHITE	9	WHITE DIE SET	WHITE (4)	W3CRT (2)	W3CRT (2)	W3CRT (2)	W3CRT (2)	W3CRT (2)	----- B3CD(1) A3CD(1) Y34PR	U3CRT(2)	U3CRT(2)	U3CRT(2)	-----	-----		1-5/16"
YA2C2N	BROWN	10	BROWN DIE SET	BROWN(4)	X2CRT(2)	W2CRT(2) W2CVT(2)	W2CRT(2) W2CVT(2)	W2CRT(2) W2CVT(2)	X2CRT(2) W2CRT(2) W2CVT(2)	----- B2CD(1) A2CD(1) Y34PR	U2CRT(2)	U2CRT(2)	U2CRT(2)	-----	-----		1-5/16"

- NOTES:
- MATERIAL: COPPER TUBING
 - FINISH: TIN PLATED. FOR UNPLATED VERSION, ADD SUFFIX "BR" TO CATALOG NUMBER EX. YA6C2NBR.
 - CATALOG # PT6515 ADAPTOR IS REQUIRED TO USE "U" DIES IN Y45 SERIES TOOLS.
 - CATALOG # PUADP-1 ADAPTOR IS REQUIRED TO USE "U" DIES IN Y46 SERIES TOOLS.
 - Y35P3 INDENTOR ADAPTOR REQUIRED FOR Y34PR INDENTOR.
 - PERMANENT DIE IN TOOLING.
 - DIMENSIONS IN BRACKETS [] ARE IN MILLIMETERS ROUNDED OFF TO THE NEAREST MILLIMETER, UNLESS OTHERWISE NOTED, AND ARE FOR REFERENCE ONLY.
 - FOR USE BY CUSTOMERS THAT HAVE THIS HYPRESS™ NO NEW Y34A HYPRESS™ TOOLS ARE BEING PROCESSED. Y34A USES A--D TYPE NEST DIES.
 - CONNECTORS ARE UL LISTED; UNDRILLED VERSIONS ARE NOT UL LISTED.
 - CONNECTORS ARE CSA CERTIFIED; UNDRILLED VERSIONS ARE NOT CSA CERTIFIED.
 - FOR UNDRILLED VERSIONS ADD SUFFIX "-U" TO END OF CATALOG NUMBER. FOR UNDRILLED VERSIONS, USE D MIN. = N MAX. + E MIN. + Z MIN.
 - "X", "W-RT", "W-VT", "U", & "L" DIE SETS ARE COLOR CODED. "A", "B", AND "C" DIES ARE NOT COLOR CODED. NESTS AND INDENTOR TYPE ARE NOT COLOR CODED.
 - X8CABT & U8CABT DIES USED ON YA6C-- HYLUG™ NOT YA5C-- HYLUG™

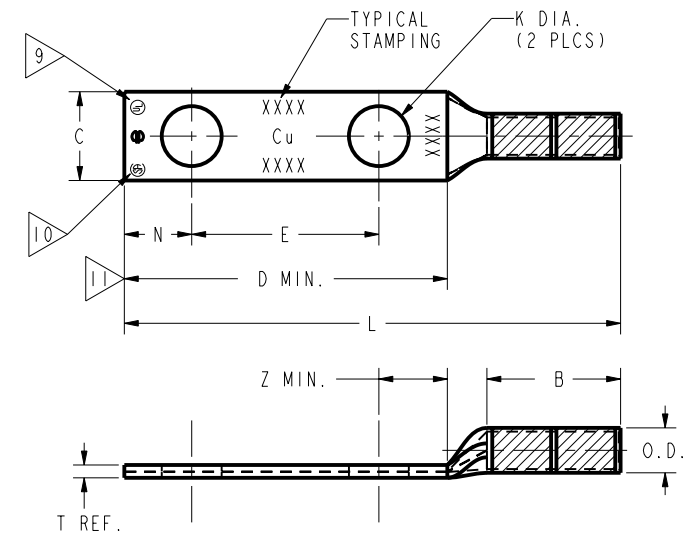

REFERENCE: SE209513

TO ORDER BURNDY® PRL	HYLUG™	
	ITEM NO:	N/A
	CAT. NO:	YA--2N (SEE TABLE)
	DRAWN BY:	J MICHAUD 11/18/94
	CHECKER:	D FILLION 11/18/94
	DSN APPVL:	C PALAGI 10/24/94
	MFG APPVL:	--
	QA APPVL:	C ACKERMAN 11/17/94
	MKT APPVL:	T NELSON 11/10/94
	PROD FAM:	CM&R COMPRESSION
PROJECT #:	SIZE	
DOCUMENT TYPE:	Sales	
REL LEVEL:	Released	
DRAWING NO		SCALE: NTS
SD031189		REV
SHEET 1 OF 10		C

REV: PEO200